

# LEXINGTON TWP, JOHNSON COUNTY, KANSAS

## PRECINCT BOUNDARIES

Date: 5/12/2026

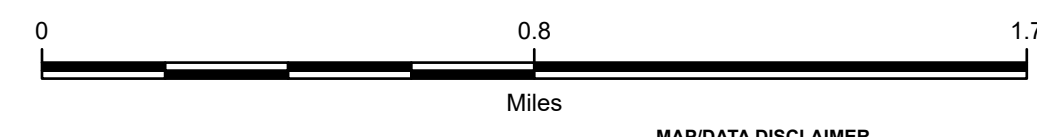
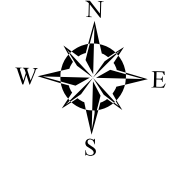
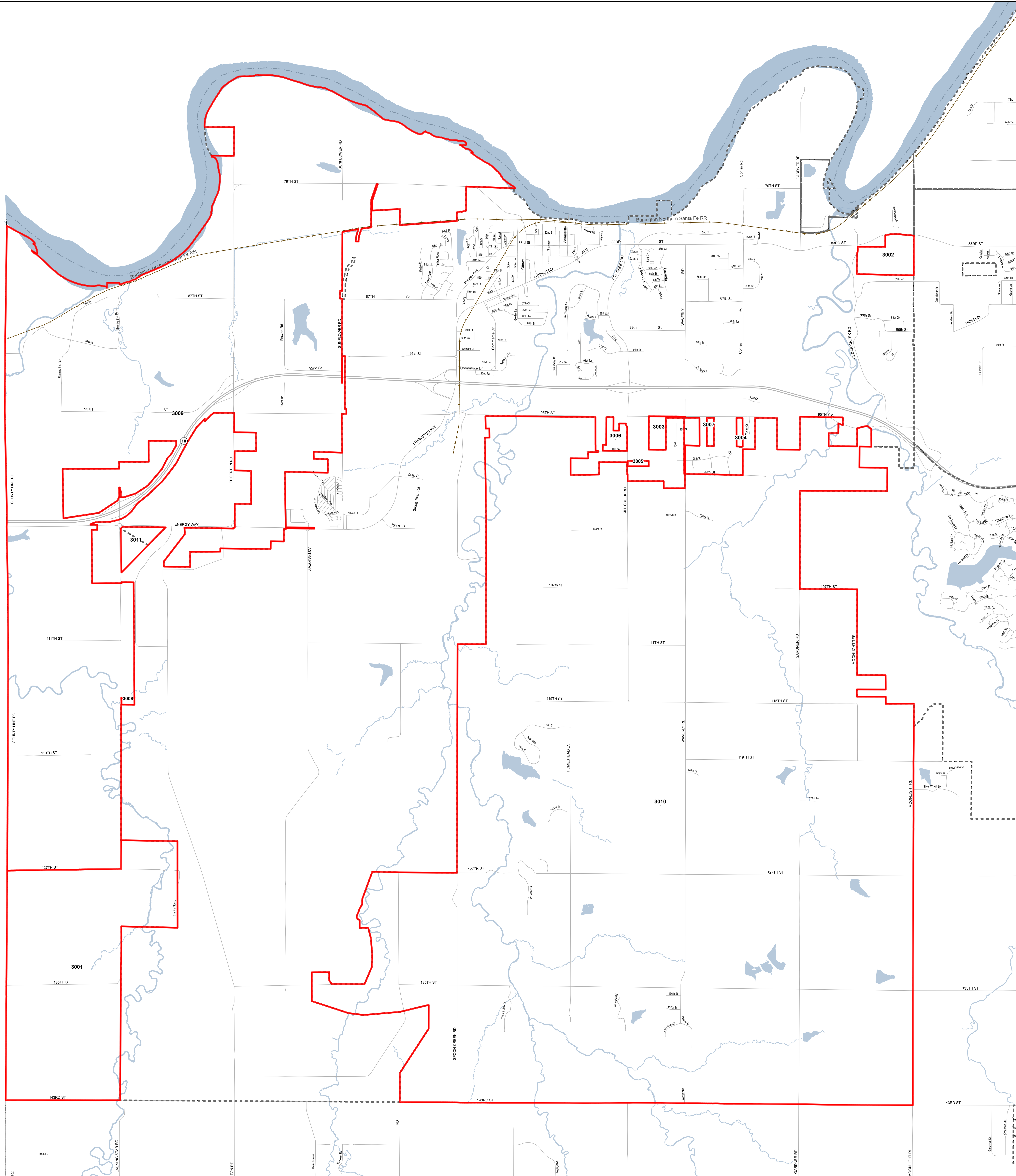

**JOHNSON COUNTY**  
KANSAS  
AIMS GIS & Mapping

**MAP/DATA DISCLAIMER**  
It is understood that while the AIMS participating agencies and information suppliers have not indicated and reason to believe that there are inaccuracies in information incorporated in the base map, AIMS AND ITS SUPPLIER MAKE NO REPRESENTATION OF ANY KIND, INCLUDING BUT NOT LIMITED TO WARRANTIES OF MERCHANTABILITY OR FITNESS FOR A PARTICULAR USE, NOR ARE ANY SUCH WARRANTIES TO BE IMPLIED WITH RESPECT TO THE INFORMATION, DATA, OR SERVICE FURNISHED HEREIN.

### Legend

- Voting Precinct Boundary

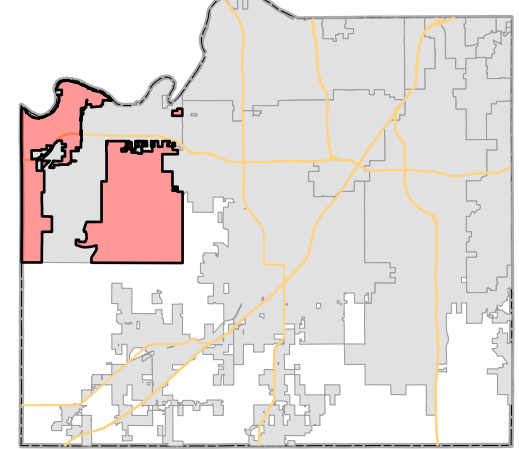

**JOHNSON COUNTY**  
KANSAS  
**Election Office**

2101 E. Kansas City Road, Olathe, Kansas 66061  
913-715-6800 | www.jocoelection.org  
@jocoelection | F/jocoelection